



1 of 2 – 2014, 1 of 2 – 2013 Kenworth T800 Combo, 1 of 2 – 2014 & 2013 Rebel 17465 Litre



2015 Kenworth C500 360 In.



2017 Kenworth T800 Heavy Haul



2014 Caterpillar D6T LGP



1 of 2 – 2014 Caterpillar 336EL

Edmonton, AB
 October 23–26, 2018 (Tue–Fri)

Unreserved public auction



3 – 2014 Volvo A40G 6x6

Edmonton, AB

October 23–26, 2018

Tue–Fri 8:00 am

Phone: **780.955.2486**

Fax: 780.955.2662

Auction location: 1500 Sparrow Dr, Nisku, AB T9E 8H6

5,000+ items & counting

Bid in person or online

On-site registration starts: **Oct 20 (Sat)**

Inspection hours: **Mon–Fri, 8 am–5 pm**
Oct 20–21 (Sat–Sun) & Oct 27 (Sat) for load out 8 am–5 pm

Items must be removed by: **Nov 9 (Fri)**

Auction company license #303043

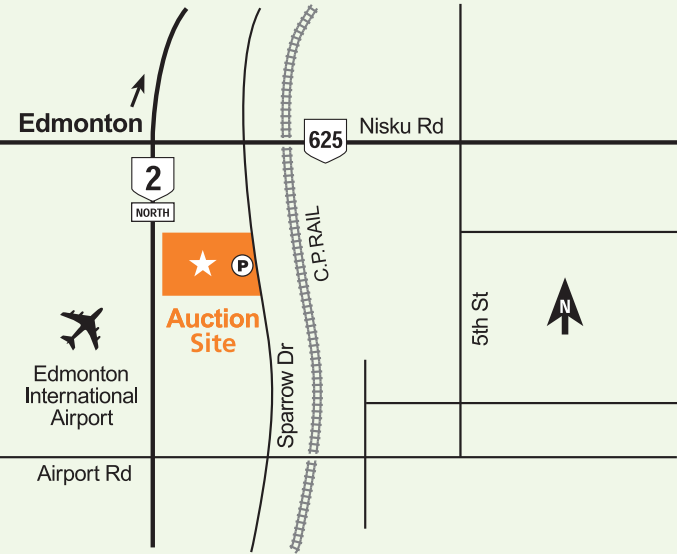

Car rentals

Take advantage of exclusive rental car discounts.

AVIS code: C039702 | **Budget code:** A062002

Auction highlights

A complete dispersal for:
A&R Reclamation Ltd.
All In Industries Ltd.
ASAP Heating & Well Servicing Corp.
Ella Mae Energy Services Ltd.
J Hayes Contracting Ltd.
Jodek Industries Ltd.

A major realignment for:
Beauregard & Sons Hauling Ltd.
Cara Dawn Transport Ltd.
Dynamic Heavy Haul Ltd.
Gibson Welding Ltd.
Nivek Oilfield Hauling
TJ's Oilfield

Equipment from:
Arnett & Burgess Pipeliners Ltd.
Big Freight Systems Inc.
Big Steam Oilfield Services Ltd.
Pidherney's Inc.
and other owners.

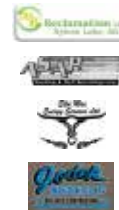

Auction notes

- ▶ Every item is sold 'as is, where is'
- ▶ International and online bidders – you may need to place a refundable deposit before you bid – check the auction details on our website for more information
- ▶ Transaction fee: (a) 10% on all lots selling for \$5,000 or less, (b) 3.85% on all lots selling for over \$5,000 up to \$33,500, with a minimum fee of \$500 per lot or, (c) \$1,290 on all lots selling over \$33,500.

Directions to auction site

From Edmonton city limits, approx 20 km South.

From Edmonton Int'l Airport, approx 2 km East to Sparrow Drive, then 1 km North to auction site.

Parking attendants and shuttle buses will be provided for your convenience. For viewing purposes, on-site shuttle service will be provided on Oct 19–26, 8 am–4 pm. Designated non parking areas within the Nisku Park will carry fines.

Visit rbauction.com for complete auction information

- Full equipment listings, more photos and detailed equipment information
- New additions to each auction – items added daily!
- Deposit and payment information, including financing, wire transfer accounts and taxes
- Full auction schedule, with times and lot numbers
- Maps, hotels and other local services

Please note

At Ritchie Bros., our commitment to safety is unreserved. Buyers and sellers are responsible for arranging the unloading and loading items which exceed the capacity or safe-lifting ability of Ritchie Bros.' forklifts and loaders, operating as a single machine.

Construction and road closure notice near our nisku auction site

To our valued customers and transporters, please be aware of the following road closure:

Sparrow Drive Culvert Replacement – Oct 2nd to Oct 31st

The section of Sparrow Drive, South of Highway 625 and North of Airport Road will be closed to traffic for a culvert replacement from Oct 2nd to October 31st. The typical hours of construction will be 7 a.m. to 7 p.m.

Traffic will be detoured around the area for the duration of the project. Local access to businesses will be maintained.

All construction areas will be marked by barricades and road closure signs.



1 of 2 – Caterpillar 583H



1 of 2 – 2012 Caterpillar D6T LGP



Caterpillar D9R



1 of 3 – Caterpillar D8T



1 of 2 – Caterpillar D8R Series II



2009 Caterpillar D7R LGP Series II



Caterpillar D7R LGP Series II



2 of 3 – 2012 Caterpillar D7E



1 of 3 – 2011 Caterpillar D6T LGP



2 of 3 – Caterpillar D6R LGP Series III



2011 Caterpillar D6N LGP



2014 John Deere 850K LGP w/Topcon GX30



2011 John Deere 750J LGP



2011 John Deere 650J LGP



2013 Komatsu D51PX-22



2015 Caterpillar 924K



2012 Caterpillar 908H2



Caterpillar IT38G Series II



2012 JCB 457ZX



2011 John Deere 844K



2015 John Deere 624K



2015 Bobcat S590



2015 John Deere 333E



2015 John Deere 872G AWD



2013 John Deere 870GP



1 of 2 – 2011 John Deere 870GP



2009 John Deere 870D



2013 John Deere 772G AWD



2012 John Deere 772G AWD



2011 John Deere 772GP AWD



1 of 2 - 2012 Caterpillar 336EL



2013 Caterpillar 320EL



2012 Hitachi ZX470LC-5



2013 John Deere 470G LC



2017 John Deere 350G LC



1 of 3 – 2012 John Deere 290G LC



2016 John Deere 245G LC



2012 John Deere 225D LC



2017 John Deere 210G LC



2016 Komatsu PC290LC-11



1 of 2 – 2014 Komatsu PC290LC-10



2014 Komatsu PC210LC-10



2012 Volvo EC480DL



2 – Volvo A30D 6x6



Liebherr LTM1080-1 90 Ton 8x8x8



Terex RT780 4x4x4



2012 & 2011 John Deere 953K



2013 Caterpillar CS56B



2013 John Deere 2154D



2012 John Deere 2154D



2011 John Deere 2154D



Roadtec SB2500C 4x4 Shuttle Buggy



2009 Barko 640 Mulcher



Rayco C87FMXPY Remanufactured Mulcher



2012 Peterbilt 367 Winch



2014 Kenworth C500 Winch



1 of 2 - Kenworth C500 Winch



2013 Peterbilt 367 Winch



2011 Western Star 4900SA Winch



Caterpillar 740 6x6 Bed



Kenworth C500B Bed



2012 Kenworth T800W & 2011 Peterbilt 367



5 of 7 - 2014 Kenworth T800



2 - 2010 Kenworth W900



2013 Kenworth T800 Wide Hood



1 of 2 - 2009 Kenworth T800



1 of 2 - 2011 Mack CXU613



2016 Peterbilt 389



2013 Peterbilt 388



2014 Western Star 4900SF



2015 Caterpillar CT660S



1 of 4 - 2012 Kenworth T800



2014 Kenworth T880 & 2013 Cancade 17 Ft



1 of 2 – Kenworth T800



1 of 2 – 2016 Freightliner 122SD 22750 Litre



2 of 3 – 2015 Kenworth T800 Hot Oiler



2013 Freightliner Coronado SD112 15800 Litre Pressure



2014 Kenworth T800 15 K Pressure



2012 Kenworth T800 Hot Oiler



Western Star 4900SA 11255 Litre Hot Oiler



Western Star 4900SA 12080 Litre Pressure



2011 Western Star 4900 21904 Litre



2015 Kenworth T880 w/Weldco WHL23TC75



2012 Kenworth T800



2013 Kenworth C500 w/Weldco WHL35TC75



2013 Kenworth C500 w/Weldco WHL35TC75



2013 Peterbilt 367 w/Weldco HL30TC70



2015 Western Star 4900SA w/Manitex 3071C



International 7600 Jetter



2015 Kenworth T800 Hydro Vac



2013 Kenworth T800



2012 & 2011 Freightliner M2106 4x4



Freightliner M2106 4x4



2011 International 7500 SBA Boiler,
2 - 2012 & 2010 International 7400 SBA Boiler



2011 Kenworth T370 Steam



Peterbilt 340



2012 Western Star 4900SA



6 of 7 – 2015 Ford F350 4x4



2013 International 7400 Workstar 4x4



International 5600i Coil Tubing



Mack CV713 Granite & International 5600 Down Hole Foam



Kenworth T800B Coil Tubing



International MXT 4x4



2013 International CE 4x4 18 Passenger & 2010 International CE 4x4 32 Passenger



1931 Ford Model A



2 – 2010 CMI C250



2 – 2011 CMI C400



Aspen 60 Ton 3+1 Combination



2012 Peerless 24 Wheel, 2012 Peerless 45 Ton 16 Wheel & 2012 Peerless 20 Ton



2009 Peerless LB65SR50E24A 24 Wheel



Peerless LB50LDBTMLN3A Combination



2012 Peerless 24 Wheel



2013 Doepker Super B-Train



Gerrys Low Pro 60 Ton 16 Wheel



2018 Arctic HR48QD 51 Ft



2017 Cross Country Super B-Train



2014 Midland MC38MX3000 38 Ft



2016 Arnes 29 Ft & 1 of 2 - 2014 Arnes 30 Ft



2011 Gentex DF44 14000000 BTU Super Heater



2016 Stephens 31800 Litre



1 of 7 – 2011 60 x 12 Ft Wellsite



2 – 2012 & 2010 Alta-Fab 60 x 12 Ft Wellsite



2 – Unused – 2018 Genie GTH3007 4x4x4 & 4 – Unused – 2018 GTH2506 4x4x4



John Deere 9420



2009 Challenger MT865C



Challenger MT865B



2014 John Deere 6170M & Leon M3530 12 Ft



2012 John Deere 6170R



1 of 3 – 2013 John Deere S680



1 of 2 – 2011 Dragflow DRH400 Submersible Dredge



3 of 4 – Pisten Bully PB600



Prinoth BR275



Western Star 4900SA Rod Rig



Monaco Camelot Class A 42 Ft



Roadmaster Holiday Rambler Navigator 45 PBT



1 of 6 – Enclosed 2013 Shindaiwa 100 KW



6 of 9 – 2011 Allmand Bros. 20 KW w/2000 Litre Fuel



1 of 2 – 2016 Tysea V



RPM Tech Inc. LM220

Real estate selling from this auction

Marcel and Janet Van Hecke

135.48± Title Acres – **Approved Strathcona County Area Structure Plan**
 4730± Sq Ft Home plus 1500± Sq Ft Second Residence
 7700± Sq Ft Shop & (2) 2000± Sq Ft Shops – Sherwood Park, AB



135.48± titled acres with approved Strathcona County Area Structure Plan.

The property is located just 30 minutes from Edmonton's downtown core. It is strategically located in the County of Strathcona's Energy Heartland District on the Westside of Hwy 21 and 3.2 km (2 miles) North of Sherwood Park. It is in close proximity to the Capital Region Sewage Line and treatment plant situated 2.4 km (1.5 miles) to the West. A CP rail line runs through the Southeast portion of the property as does a regional waterline.

Access to Hwy 21 is by 2 existing at grade, all directional intersections at the North and South ends of the property. A direct connection into the interchange at Anthony Henday Drive is now available through Township Rd 534 which borders the southside of the property and leads into Aurum Rd.

The property is well appointed with a 4730± sq ft home, 1500± sq ft second residence, 7700± sq ft shop, (2) 2000± sq ft shops, 4000± sq ft storage quonset, horse barn and small livestock barn, man-made fish-stocked lake, irrigated lawns and garden, extensive concrete and paved driveways.

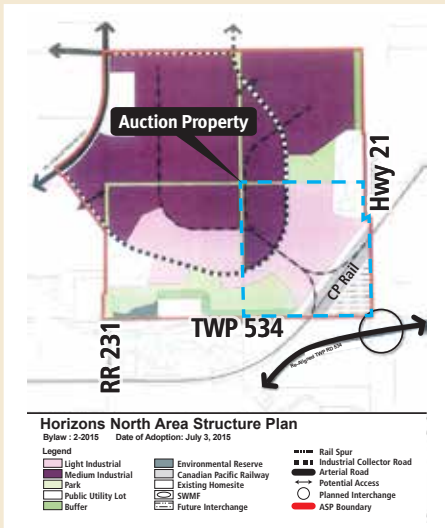

Property may be viewed by appointment

Owner – Marcel Van Hecke: 780.467.1538
 Ritchie Bros. Real Estate – Jerry Hodge: 780.706.6652
 Brokerage – Ritchie Bros. Real Estate Services Ltd.

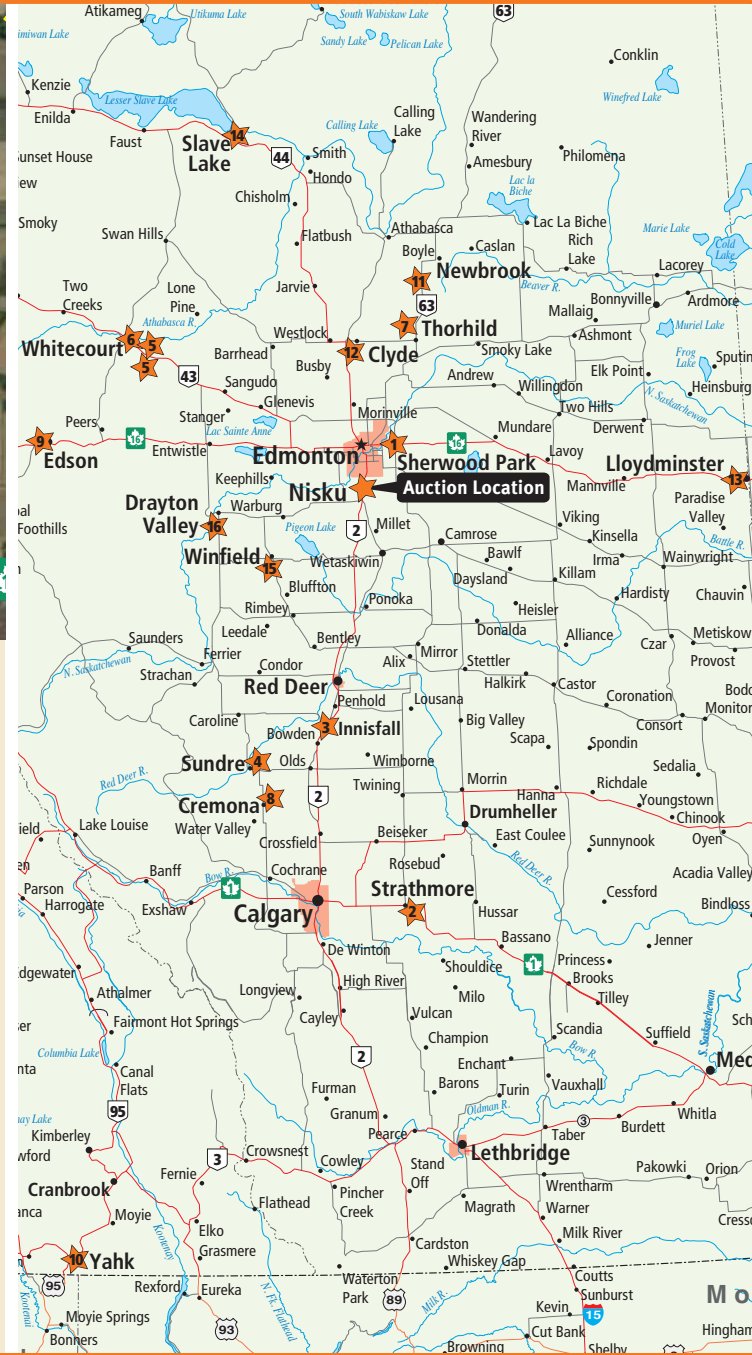

Real estate selling from this auction

Property may be viewed without an appointment



Bridget Mathews

1 Parcel of Farmland – 136.39± Title Acres
\$5300 Surface Lease Revenue – Strathmore, AB

Contact – Daryl Glenn: 403.899.3900
Ritchie Bros. – Brad Goossen: 587.223.0053
Ritchie Bros. Real Estate – Jerry Hodge: 780.706.6652
Brokerage – Ritchie Bros. Real Estate Services Ltd.

2

Property may be viewed without an appointment

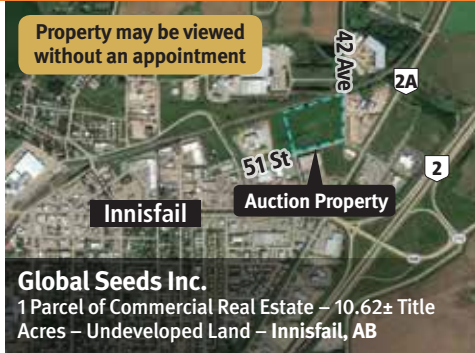

Global Seeds Inc.

1 Parcel of Commercial Real Estate – 10.62± Title Acres – Undeveloped Land – Innisfail, AB

Owner – Dave Surkan: 403.318.2000
Ritchie Bros. Real Estate – Jerry Hodge: 780.706.6652
Brokerage – Ritchie Bros. Real Estate Services Ltd.

3

Property may be viewed without an appointment



1029440 Alberta Ltd.

1 Parcel of Farmland – 143.18± Title Acres
3.3 Million ± Tonnes Proven Gravel Reserves
\$5000 Surface Lease Revenue – Sundre, AB

Contact – Paul Leussink: 403.556.0377
Ritchie Bros. Real Estate – Jerry Hodge: 780.706.6652
Brokerage – Ritchie Bros. Real Estate Services Ltd.

4

Property may be viewed without an appointment

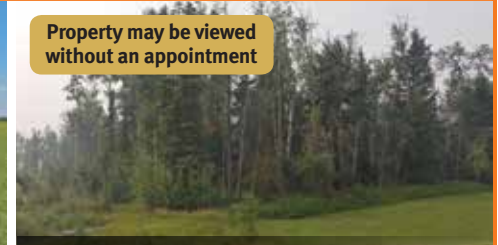

1325415 Alberta Ltd.

3 Parcels of Real Estate
2 Residential Acreages – 5.49± & 5.26± Title Acres
160 ± Title Acres Land – Whitecourt, AB

Owner – Brian Davies: birkonna@gmail.com
Ritchie Bros. Real Estate – Jerry Hodge: 780.706.6652
Brokerage – Ritchie Bros. Real Estate Services Ltd.

5

Property may be viewed without an appointment



890801 Alberta Ltd.

1 Parcel of Industrial Real Estate
73.1± Title Acres – Hwy 43 Frontage
\$2228 Power Line Revenue – Whitecourt, AB

Owner – Ken Adams: 780.778.9540
Ritchie Bros. Real Estate – Jerry Hodge: 780.706.6652
Brokerage – Ritchie Bros. Real Estate Services Ltd.

6

Property may be viewed without an appointment



Dorval and Colleen Perrin

1 Parcel of Farmland
149.61± Title Acres – Thorhild, AB

Owner – Dorval Perrin: 780.576.2384
Ritchie Bros. Real Estate – Jerry Hodge: 780.706.6652
Brokerage – Ritchie Bros. Real Estate Services Ltd.

7

Property may be viewed without an appointment

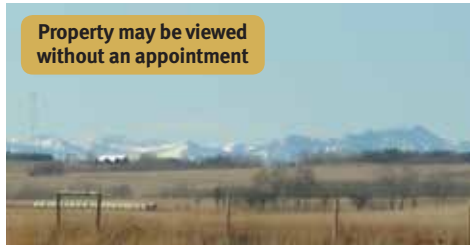

Heather Clifford

3 Country Residential Acreages – Mountain Views
2.03±, 2.12± & 2.02± Title Acres – Cremona, AB

Owner – Heather Clifford: 403.337.2537
Ritchie Bros. Real Estate – Jerry Hodge: 780.706.6652
Brokerage – Ritchie Bros. Real Estate Services Ltd.

8

Property may be viewed without an appointment



Estate of Hazel McClarty

151.97± Title Acres – Undeveloped Land
\$2788 Surface Lease Revenue – Town of Edson, AB

Ritchie Bros. Real Estate – Jerry Hodge: 780.706.6652
Brokerage – Ritchie Bros. Real Estate Services Ltd.

9

Property may be viewed by appointment



Grouse Mountain Store & Campground

Convenience Liquor Store, Gas Station & Campground
Situated on the Moyie River – Yahk, BC

Owner – Robert King: 780.836.5109
Ritchie Bros. Real Estate – Jerry Hodge: 780.706.6652
Realtor® – Tom Moran PREC*: 250.784.7090
Brokerage: Re/Max Dawson Creek Realty

10

Property may be viewed by appointment



Alberta Mini Storage

Newbrook RV Park – 8.66± Title Acres
40 Year Round RV Site Campground – Newbrook, AB

Contact – Dustin Kostiw: 780.448.9458, 780.691.1183 (c)
Ritchie Bros. Real Estate – Jerry Hodge: 780.706.6652
Brokerage – Ritchie Bros. Real Estate Services Ltd.

11

Property may be viewed without an appointment



Lon & Donna Tollenaar

1 Parcel of Farmland
71.27± Title Acres – Hwy 2 Frontage – Clyde, AB

Owner – Lon Tollenaar: 780.283.0186
Ritchie Bros. Real Estate – Jerry Hodge: 780.706.6652
Brokerage – Ritchie Bros. Real Estate Services Ltd.

12

Real estate selling from this auction

Open House:
October 17 – 5 to 7 pm



K&C Oilfield
2 Parcels of Industrial Real Estate
4.74± Title Acres w/11,000± Sq Ft Industrial Shop & Office
3.11± Title Acres – County Energy Park – Lloydminster, AB

Ritchie Bros. Real Estate – Jerry Hodge: 780.706.6652
Brokerage – Ritchie Bros. Real Estate Services Ltd.

13

Open House:
October 13 – 2 to 4 pm



Jay Enterprises
8800± Sq Ft (8) Unit Multi-Tenant Commercial Strip Mall
0.36± Title Acres – Slave Lake, AB

Ritchie Bros. Real Estate – Jerry Hodge: 780.706.6652
Brokerage – Ritchie Bros. Real Estate Services Ltd.

14

Open House:
October 18 – 5 to 7 pm



Paradox Access Solutions Inc
1 Parcel of Industrial Real Estate – 2.97± Title Acres
3600± Sq Ft Shop & Office – Winfield, AB

Contact – Marc Breault: 587.461.1500
Ritchie Bros. Real Estate – Jerry Hodge: 780.706.6652
Brokerage – Ritchie Bros. Real Estate Services Ltd.

15

**Property may be viewed
by appointment**



Kay-Son RV Park
RV Park and Campground – 51 Serviced Sites and 6 Cabins
11.3± Title Acres – 2000± Sq Ft Shop
Stocked Fish Pond – Drayton Valley, AB

Owners – Cory or Amanda Townsend: 780.202.0045
Ritchie Bros. Real Estate – Jerry Hodge: 780.706.6652
Brokerage – Ritchie Bros. Real Estate Services Ltd.

16

Modular homes selling from the Edmonton October auction

**Property may be viewed
by appointment**



Bryon & Elise Oro
2012 Forest River Housing Inc. Modular Home
1216± Sq Ft – 3 Bedroom, 2 Bathroom – Millet, AB

Contact – Bryon Oro: 780.994.3225
Ritchie Bros. Real Estate – Jerry Hodge: 780.706.6652

Open House:
October 20 – 2 to 4 pm



Whissell Land Corp.
2008 Winalta Modular Home
1416± Sq Ft – 3 Bedroom, 2 Bathroom – Keephills, AB

Contact – John Whissell: 780.819.2512
Ritchie Bros. Real Estate – Jerry Hodge: 780.706.6652

Real estate selling from the Edmonton December auction

Open House Dates:
November 3 & 17 – 2 to 4 pm

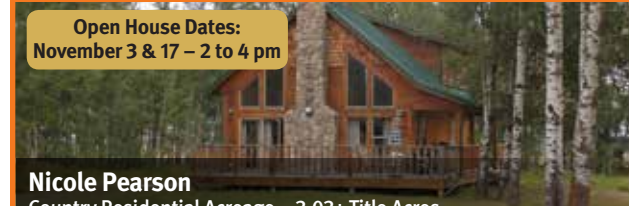

Nicole Pearson
Country Residential Acreage – 3.03± Title Acres
1382± Sq Ft Residence – 2000± Sq Ft Shop – Spruce View, AB

Owner – Nicole Pearson: 403.304.0517
Ritchie Bros. Real Estate – Jerry Hodge: 780.706.6652
Brokerage – Ritchie Bros. Real Estate Services Ltd.

Open House Dates:
November 10 & 24 – 2 to 4 pm



Simone Reese
1 Parcel of Real Estate – 2400± Sq Ft Lakeview Home
Lake Okanagan Resort – Kelowna, BC

Owners Representative – Darren Baumgardner: 780.288.8650
Ritchie Bros. Real Estate – Jerry Hodge: 780.706.6652
Realtor® – Tom Moran PREC*: 250.784.7090 Brokerage: Re/Max Dawson Creek Realty

**Property may be viewed
by appointment**



Norbert & Darlene Loiselle
2 (1 Bedroom, 1 Bathroom) Apartment Style Condos
Clearwater Courts Complex – Fort McMurray, AB

Owner – Norbert Loiselle: 306.479.8998
Ritchie Bros. Real Estate – Jerry Hodge: 780.706.6652
Brokerage – Ritchie Bros. Real Estate Services Ltd.

**Property may be viewed
without an appointment**



Raymond & Jody Marquette
2 Parcels of Farmland
155.01± & 161± Title Acres – Westlock, AB

Owner – Raymond Marquette: 780.307.4097
Ritchie Bros. Real Estate – Jerry Hodge: 780.706.6652
Brokerage – Ritchie Bros. Real Estate Services Ltd.

For auction and property details visit:
rbauction.com/realestate

Equipment listings

Construction

PIPELAYERS: 2- Caterpillar 583H • Caterpillar 561H • Caterpillar 561C w/2003 Danlift Hyd.

59- CRAWLER TRACTORS: Caterpillar D9R • 3- Caterpillar D8T • Caterpillar D8R • 2- Caterpillar D8R Series II • Caterpillar D8N • Caterpillar D8K • 2009 Caterpillar D7R LGP Series II • Caterpillar D7R • Caterpillar D7R LGP Series II • Caterpillar D7R Series II • 2- Caterpillar D7H • 3- 2013 & 3- 2012 Caterpillar D7E • 2014 & 2013 Caterpillar D6T LGP • 2012 Caterpillar D6TXW • 2- 2012 Caterpillar D6T LGP • 2011 Caterpillar D6TXW • 3- 2011 Caterpillar D6T LGP • Caterpillar D6T LGP • Caterpillar D6R LGP • Caterpillar D6R XW • 3- Caterpillar D6R LGP Series III • 2011 Caterpillar D6N LGP • 3- Caterpillar D6N LGP • 2011 Caterpillar D6K LGP • 2015 Caterpillar D3K2 LGP • 2013 Caterpillar D3K2 SLGP • Caterpillar D3K LGP • Caterpillar D3G LGP • 2014 John Deere 850K LGP • 2011 John Deere 850J • 2013, 2012 & 2011 John Deere 750J LGP • John Deere 750J LGP • 2011 & 2009 John Deere 650J LGP • John Deere 650J LGP • 2014 John Deere 450J LGP • John Deere 450J LGP • 2011 Komatsu D85PX-15EO • 2011 Komatsu D65PX-17 • 2013 Komatsu D51PX-22.

33- WHEEL LOADERS: 2014 Case 921F • Case 621E • Caterpillar 980G Series II • Caterpillar 966G Series II • 2- Caterpillar 966C • 2013 Caterpillar 950H • 2011 Caterpillar 950H • 2- Caterpillar 950H • 2- Caterpillar 950E • 2- 2013 Caterpillar 938K • Caterpillar 936 • 2015 Caterpillar 924K • Caterpillar 924G • 2012 Caterpillar 908H2 • Caterpillar IT38G Series II • 2016 Gehl AL540 • Hyundai HL757TM-9 Integrated Tool Carrier • 2012 JCB 457ZX • JCB 416HT • 2014, 2013 & 2011 John Deere 844K • John Deere 644H • 2015 John Deere 624K • John Deere 544J • Komatsu WA320-1 • Komatsu WA150-5 • Trojan • Volvo L330E.

CRAWLER LOADERS: Caterpillar 963C.

DUMPERS: Yanmar YFW45R Crawler.

25- SKID STEER LOADERS: 2014 & 2011 Bobcat S770 2 Spd • 2014 Bobcat S650 2 Spd • 2015 & 2014 Bobcat S590 2 Spd • 2014 Bobcat S570 2 Spd • Bobcat S250 • Bobcat S205 2 Spd • 2- Bobcat S205 • Bobcat S130 • Case 1845C • Case 440CT • 2012 Caterpillar 279C • 2011 Caterpillar 272C • Caterpillar 262C • 2- 2012 Caterpillar 246C • Caterpillar 246C • Caterpillar 242B • Caterpillar 236B 2 Spd • 2012 John Deere 326D 2 Spd • 2- John Deere 320 • 2018 Kubota SSV75.

41- MULTI TERRAIN LOADERS: 2012 Bobcat T870 2 Spd Compact Track • 2013 Bobcat T770 Compact Track • 2- 2012 & 2011 Bobcat T770 2 Spd Compact Track • 2013 Bobcat T750 Compact Track • 2013 Bobcat T650 2 Spd Compact Track • 2- 2011 Bobcat T650 Compact Track • 2010 Bobcat T630 Compact Track • 2015 & 2014 Bobcat T590 Compact Track • 2- 2010 Bobcat T300 Compact Track • Bobcat MT52 Walk Behind Compact Track • 2012 Case TV380 2 Spd Compact Track • 2014 & 2012 Caterpillar 299D XHP 2 Spd Compact Track • 2012 Caterpillar 289C 2 Spd Compact Track • 2- 2013 Caterpillar 279C2 2 Spd Compact Track • 2012 Caterpillar 279C2 Compact Track • 2013 Caterpillar 279C 2 Spd Compact Track • 2012 Caterpillar 277C2 2 Spd • 2013 Ditch Witch SK750 Ride On Compact Track • 2010 Ditch Witch SK650 Walk Behind Compact Track • 2015 John Deere 333E 2 Spd Compact Track • 2013 John Deere 329D Compact Track • 2011 John Deere 329D 2 Spd Compact

Track • 2013 John Deere 323D 2 Spd Compact Track • John Deere CT322 Compact Track • 2015 Kubota SVL75-2 Compact Track • 2011 Kubota SVL75 2 Spd Compact Track • 2014 Mustang 2100RT 2 Spd Compact Track • 2012 New Holland C227 Compact Track • 2010 New Holland C175 Compact Track • Takeuchi TL130 Compact Track • 2010 Terex PT60 2 Spd Compact Track • 2014 Terex PT30 Compact Track • 2- Terex PT30 Compact Track.

27- MOTOR GRADERS: Case 885 • 2- 2013 Caterpillar 160M2 AWD VHP Plus • Caterpillar 160M • Caterpillar 160H VHP Plus • 2- Caterpillar 160H VHP • 2014 Caterpillar 140M2 VHP Plus • 2011 Caterpillar 140M • 4- Champion 720A • 2015 John Deere 872G AWD • 2011 John Deere 872G • 2013 & 2- 2011 John Deere 870GP • 2009 John Deere 870D • 2011 John Deere 772GP AWD • 2013 & 2012 John Deere 772G AWD • John Deere 772D AWD • 2013 & 2009 John Deere 770G • John Deere 770CH • John Deere 672D AWD.

53- HYDRAULIC EXCAVATORS: 2013 Caterpillar 349EL • 2- 2014, 2013 & 2- 2012 Caterpillar 336EL • Caterpillar 330DL • 2011 Caterpillar 329DL • Caterpillar 325DL • 2013 Caterpillar 320EL • Gradall XL3200 • 2012 Hitachi ZX470LC-5 • Hitachi ZX330LC • 2010 Hitachi ZX270LC-3 • Hitachi ZX270LC-3 • Hitachi ZX270LC • 2014 Hitachi ZX250LC-5 • Hitachi ZX240LC-3 • Hitachi EX150 • John Deere 892E LC • 2012 John Deere 870G LC • 2013 John Deere 470G LC VG • John Deere 450D LC • 2013 John Deere 350G LC • 2017 John Deere 350G LC • 2013 John Deere 290G LC • 2014 & 3- 2012 John Deere 290G LC • 2011 John Deere 290G • 2013 John Deere 250G LC • 2016 John Deere 245G LC • 2011 John Deere 240D LC • 2011 John Deere 225D LC • 2013 & 2012 John Deere 225D LC • 2017 John Deere 210G LC • John Deere 160D LC • John Deere 135D • Kobelco K916LC Mark II • Kobelco ED150-1E • 2016 Komatsu PC290LC-11 • 2- 2014 Komatsu PC290LC-10 • 2012 Komatsu PC240LC-10 • Komatsu PC220LC-7 • 2014 Komatsu PC210LC-10 • Kubota • 2012 Volvo EC480DL • Volvo EC290BLC • 2014 Volvo EC220DL • 2011 Volvo EC160CL.

MOBILE EXCAVATORS: 2011 Hitachi ZX220W-3.

MIDI EXCAVATORS: 2017 Caterpillar 308E2CR • Caterpillar 308C • John Deere 75C • 2014 Kubota KX080-4 • 2012 Takeuchi TB153FR • 2013 Yanmar Vi055-5B.

12- MINI EXCAVATORS: 2012 Bobcat E35 • 2011 Caterpillar 305DCR • 2015 Caterpillar 305.5E2CR • 2015 Caterpillar 303.5E2 CR • 2013 Caterpillar 302.7D • 2012 Caterpillar 301.8C • 3- 2015 JCB 8029CTS • Kubota KX021 • 2012 Takeuchi TB138FR • 2013 Takeuchi TB108.

17- ARTICULATED DUMP TRUCKS: 3- Caterpillar 740 6x6 • 2011 John Deere 300D 6x6 • 2013 Komatsu HM400-3 6x6 • 2014 Komatsu HM300-3 6x6 • Terex TA30 6x6 • 2- Terex TA30 6x6 • 3- 2014 Volvo A40G 6x6 • 2010 Volvo A40E 6x6 • Volvo A40E 6x6 • Volvo A35D 6x6 • 2- Volvo A30D 6x6.

TRENCHERS: 2012 Barreto E924HM4MS Walk Behind • 2014 Ditch Witch Hydraulic • 2015 Toro RT600-25430C.

DIRECTIONAL DRILLS: 2013 Toro DD4045-23825.

LOADER BACKHOES: Case 580M 4x4 • Case 580E • Caterpillar 420EIT 4x4.

ALL TERRAIN CRANES: Liebherr LTM1080-1 90 Ton 8x8x8.

ROUGH TERRAIN CRANES: Galion C125 12.5 Ton 4x4x4 • Grove RT740 40 Ton 4x4x4 • Grove RT58C 4x4 • Grove RT48 4x4x4 • Grove PH20-21 20 Ton 4x4x4 • 2013 Tadano GR350XL-2 35 Ton 4x4x4 • Terex RT780 4x4x4.

CRAWLER CRANES: American 5299 50 Ton.

CRANES: 16 Ft Jib • Rolling Gantry.

COMPACTORS: Caterpillar 815.

VIBRATORY PADFOOT COMPACTORS: Caterpillar CP563E • Ingersoll-Rand SD70F TF • Ingersoll-Rand SD40F.

VIBRATORY SMOOTH DRUM ROLLERS: 2010 Bomag BW213DH-40 • 2013 Caterpillar CS56B • Caterpillar CS56 • Dynapac CA251A

TANDEM ROLLERS: Caterpillar CB14 • Dynapac CC421 • Unused - 2018 Hamm HD10CVV • 2- Ingersoll-Rand DD130 • 2- Ingersoll-Rand DD24 • 2- Volvo DD138 HF

ROLLERS: 2013 Caterpillar CC34 4 Wheel Combination.

ASPHALT PAVERS: Cedarapids CR461 Tracked.

ASPHALT EQUIPMENT: Bomag MPH100 Recycler Pulverizer • 2012 HDE MR75-T S/A Asphalt Recycler • Roadtec SB2500C 4x4 Shuttle Buggy.

FELLER BUNCHERS: 2012, 2011 & 2010 John Deere 953K • John Deere 853G.

PROCESSORS: John Deere 2554 • 2011 John Deere 2454D • 2013, 2012 & 2011 John Deere 2154D • John Deere 2054 Crawler.

LOG LOADERS: Caterpillar 325D FM.

SKIDDERS: Tigercat 630 Grapple.

ENVIRONMENTAL EQUIPMENT: Al-Jon T/A Car Crusher • 2009 Barko 640 Mulcher • 2- 2011 CMI C400 Mulcher • 2- 2010 CMI C250 Mulcher • 2- 2013, 2- 2012 & 2- 2010 CMI C175 Mulcher • Rayco C130 Mulcher • Rayco C87FMXPY Remanufactured Mulcher • 2016 Risley ECLIPS EV325 Mulcher • 2015 Risley ECLIPS EV325 Mulcher.

JAW CRUSHERS: Terex/Pegson Crawler Jaw Crushing Plant.

20- CONVEYORS: 8- Unused - 2018 Better BE3660C 36 In. x 60 Ft Portable • 4- Unused - 2018 Fastake 3660 36 In. x 60 Ft Portable • 4- Unused - 2018 Suihe 60 Ft Portable Radial Stacking • 4- Unused - 2018 XCG 36 In. x 60 Ft Portable.

CONTROL VANS: Kohler 250 KW.

Trucks & trailers

25- WINCH TRACTORS: Freightliner FL120SD T/A Sleeper • Freightliner Classic 120 T/A Sleeper • Kenworth T800B T/A • Kenworth T800B Tri Drive Sleeper • 4- Kenworth T800B T/A Sleeper • Kenworth T800 Tri Drive • Kenworth T800 Tri Drive Sleeper • 2- Kenworth T800 T/A Sleeper • Kenworth C500B T/A Sleeper • 2014 Kenworth C500 Tri Drive Sleeper • Kenworth C500 Day Cab T/A • Kenworth C500 T/A • Oshkosh MK48 8x8 Articulated • Peterbilt 379 T/A Sleeper • 2013 Peterbilt 367 Tri Drive Sleeper • 2012 Peterbilt 367 T/A • 2012 & 2011 Western Star 4900SA Tri Drive Sleeper • Western Star 4900SA Tri Drive Sleeper • Western Star 4900SA Tri Drive Texas Bed • 2012 Western Star Tri Drive.

10- BED & RIG-UP TRUCKS: Caterpillar 740 6x6 • Caterpillar 730 6x6 Off Highway Articulated • Kenworth C500B T/A/T/A • 2015 Kenworth C500 T/A/T/A • 3- Kenworth C500 T/A/T/A • Oshkosh MK48 20 Ton 8x8 261 In. WB Articulated • Peterbilt 387 T/A/T/A Off Highway • Rauma Doppelmayr 6x6 Off Highway.

HEAVY HAUL TRUCKS: 2012 Kenworth W900L Tri Drive Sleeper • Kenworth T800B T/A Day Cab • 2017 Kenworth T800 T/A Sleeper • 2015 Kenworth T800 T/A Sleeper • 2012 Kenworth T800 Tri Drive Sleeper • 2010 Kenworth T800 T/A.

101- TRUCK TRACTORS: Ford LTL9000 Day Cab T/A • Glidered - Freightliner Coronado 132 Sleeper T/A • 2014 Freightliner Cascadia 125 Century Sleeper T/A • 2012 & 2011 Freightliner Coronado 122 Sleeper T/A • Freightliner FLC120 Sleeper T/A • 2- Freightliner CST120 Sleeper T/A • 2- Freightliner Classic 120 Sleeper T/A • Freightliner FL60 Sleeper S/A • Freightliner Columbia Sleeper T/A • 2009 International Prostar Sleeper T/A • 2012 International Prostar Plus Sleeper T/A • 2013 International Prostar Plus Eagle Sleeper T/A • 2013 International Prostar Plus T/A • 4- 2011 International Prostar Limited Sleeper T/A • Kenworth W900B Sleeper T/A • 2- 2010 Kenworth W900 Sleeper T/A • Kenworth W900 Day Cab T/A • Kenworth W900 Sleeper T/A • 2012 Kenworth T800W Sleeper T/A • Kenworth T800B Tri Drive Sleeper • 7- 2014 Kenworth T800 Sleeper T/A • 2013 Kenworth T800 Wide Hood Sleeper T/A • 3- 2013 & 2012 Kenworth T800 Sleeper T/A • 2- 2012 Kenworth T800 Day Cab T/A • 2- 2009 Kenworth T800 Tri Drive Sleeper • 2- Kenworth T800 T/A • 3- Kenworth T800 Day Cab T/A • 5- Kenworth T800 Sleeper T/A • 2015 Kenworth T660 T/A • 2014 & 2012 Kenworth T660 Sleeper T/A • 2009 Mack GU713 T/A • 2012 Mack CXU613 Sleeper T/A • 2- 2011 Mack CXU613 Pinnacle Day Cab T/A • Mack CXN613 Day Cab T/A • Mack CXN613 Vision Day Cab T/A • Mack CX613 Sleeper T/A • Mack CH613 Day Cab T/A • Mack Vision Sleeper T/A • Mack T/A • Ottawa Commando YT50 S/A • Ottawa C50 Command Shunt S/A • 2016 Peterbilt 389 Sleeper T/A • 2012 Peterbilt 389 T/A • 2013 & 2011 Peterbilt 388 Sleeper T/A • Peterbilt 387 Sleeper T/A • 2- 2013 Peterbilt 386 Sleeper T/A • Peterbilt 379 T/A • Peterbilt 379 Sleeper T/A • Peterbilt 379 Tri Drive Sleeper • Peterbilt 378 T/A • Peterbilt 378 Day Cab T/A • 2012 Peterbilt 367 T/A • 2012, 2011 & 2009 Peterbilt 367 Sleeper T/A • Sterling A9500 Day Cab T/A • 2009 Volvo VNL630 Sleeper T/A • 2014 Volvo VNL64T630 Sleeper T/A • 2012 Volvo VNL64T Sleeper T/A • 2011 Volvo VNL64T T/A • 2013 Volvo VN Sleeper T/A • Western Star 4964EX Sleeper T/A • 2014 Western Star 4900SF Sleeper T/A • 2013 & 2010 Western Star 4900SA Sleeper T/A • Western Star 4900SA Tri Drive Sleeper • 2013, 2012 & 2- 2010 Western Star 4900FA Sleeper T/A • Western Star 4900EX Sleeper T/A.

CAR CARRIERS: Peterbilt 379 T/A 11 Car Open Sleeper.

32- DUMP TRUCKS: 2015 Caterpillar CT660S T/A • Ford F350 Custom S/A • 2014 Freightliner M2106 4x4 S/A • 2014 Freightliner 122SD Tri Drive • 2012 Freightliner SD122 Coronado SD T/A • Freightliner FLD120SD T/A • Freightliner FLD120 Tri Drive • 2014 Kenworth T880 T/A • Kenworth T800B Tri Drive Sleeper • 2013 Kenworth T800 T/A • 2013 Kenworth T800 Tri Drive Sleeper • 4- 2012 Kenworth T800 T/A • 2009 Kenworth T800 Tri Drive Sleeper • Kenworth T800 T/A • Kenworth T800 T/A • 2- Kenworth T800 Tri Drive Sleeper • 2012 Kenworth T400 T/A • 2012 Kenworth T370 T/A • 2014 Kenworth T4 T/A • Mack CTP713 T/A • 2015 Mack CXU613 T/A • Peterbilt 378 Tri Drive Sleeper • 2014 Peterbilt PB348 T/A • 2- 2014 Peterbilt 348 T/A • Sterling LT9500 T/A • Sterling T/A • Western Star 4900FA Tri Drive.

PLOW TRUCKS & SANDERS: Freightliner FLD112 T/A • Peterbilt 340.

MIXER TRUCKS: 2009 Freightliner M2112 Tri Drive.

14- WATER TRUCKS: Ford LT9000 T/A • Ford F650 XL S/A • International 9200 100 Barrel T/A • International 7400 16000 Litre T/A • 2012 International Prostar T/A • 2009 Kenworth T800 16000 Litre T/A Potable • 2009 Kenworth T800 T/A • Mack CH613 • Sterling LT9500 16670 Litre • Volvo T/A Autocar • Sleeper • 2- Volvo T/A • Western Star 4900SA 22000 Litre Tri Drive Potable • Western Star.

31- TANK TRUCKS: Ford 2000 Gallon COE Propane • 2017, 2- 2016 & 2015 Freightliner 122SD 22750 Litre Tri Drive Sleeper • 2013 Freightliner Coronado

SD122 15800 Litre Tri Drive Pressure • Freightliner 120 11000 Litre T/A Pressure Sleeper • International 7000 9455 Litre T/A Pressure • 2011 International 5900i Paystar T/A Tri Drive Rod Rig Flushby • 2015 Kenworth T800 Tri Drive Sleeper Hot Oiler • 2015 Kenworth T800 22000 Litre Tri Drive Sleeper • 2- 2015 Kenworth T800 Tri Drive Hot Oiler Sleeper • 2014 Kenworth T800 S/A Sleeper 15 K Pressure • 2013 Kenworth T800 Tri Drive Hot Oiler Sleeper • 2013 Kenworth T800 Tri Drive Sleeper • 2013 Kenworth T800 Tri Drive Sleeper Hot Oiler • 2012 Kenworth T800 Tri Drive Hot Oiler Sleeper • 2011 Kenworth T800 Tri Drive Sleeper • 2010 Kenworth T800 16000 Litre T/A Sleeper • Kenworth T800 16000 Litre T/A • Kenworth T800 T/A • 2009 Kenworth T370 S/A 15 K Pressure • Mack CL733 19080 Litre Tri Drive • Mack CL733 20280 Litre Tri Drive • Volvo T/A Potable • Western Star 4900SA 11255 Litre Tri Drive Hot Oiler • Western Star 4900SA 12080 Litre T/A Pressure • Western Star 4900SA 17700 Litre T/A • 2011 Western Star 4900 21904 Litre Tri Drive • 2011 Western Star 4900 22690 Litre Tri Drive.

25- BOOM TRUCKS: 2012 Dodge 5500HD Crew Cab 4x4 w/Ferrari F561R A4 • Dodge 5500 SLT 4x4 w/PM • 2012 Dodge Ram 5500HD Crew Cab 4x4 w/Palfinger • Ford F550 w/Fassi F65 • Ford F550 XLT 4x4 w/Hiab 035 • Freightliner FL112 Extended Cab T/A w/terex BT4792 470 • 2010 International 7400 4x4 w/Effer 130.11/4S • International 5900i Paystar T/A w/Elliot 1860 • International 4900 Crew Cab T/A w/Hiab 100 • International 4000 • 2015 Kenworth T880 T/A w/Weldco WHL23TC75 • Kenworth T800B T/A w/Manitex 2281 • 2012 Kenworth T800 Tri Drive • 2012 Kenworth T800 Tri Drive w/Palfinger PK85002EHF S1 • Kenworth T800 T/A T/A w/National 1100 • Kenworth T800 T/A Tri Drive • 2- 2013 Kenworth C500 T/A Tri Drive w/Weldco WHL35TC75 • 2015 Kenworth T370 4x4 w/Fassi 8 Ton • 2013 Peterbilt 367 T/A T/A w/Weldco HL30TC70 • 2- Sterling LT7500 T/A w/terex BT4792 • Western Star 4964 T/A w/National 856 • 2015 Western Star 4900SA T/A T/A w/Manitex 3071C.

23- VACUUM TRUCKS: Ford L9000 T/A Hydro Vac • Ford F8000 Hydro Vac • 2014 Freightliner M2106 S/A Hydro Vac • Freightliner FLD120SD Tri Drive Sleeper Combo • 2012 International 7600 13027 Litre T/A • International 7600 T/A Jetter • International 7500 T/A Hydro Vac • 2015 Kenworth T800 T/A T/A Hydro Vac • 2015 & 2- 2014 Kenworth T800 Tri Drive Sleeper Combo • 2013 Kenworth T800 Tri Drive • 2013 Kenworth T800 Tri Drive Sleeper • 2013 Kenworth T800 Tri Drive Sleeper Combo • 2009 Kenworth T800 Tri Drive Hydro Vac • Kenworth T300 S/A Hydro Vac • 2012 Peterbilt 367 Tri Drive • Volvo WG T/A • Western Star 5964S • 2009 Western Star 4900SA 10723 Litre Tri Drive Sleeper Hydro Vac • Western Star 4900FA Tri Drive Sleeper Hydro Vac • Western Star 4900A 3026 Gallon T/A Combo • Western Star 4884F T/A T/A Hydro Vac.

FUEL & LUBE TRUCKS: Chevrolet C60 S/A • 2- 2011 Ford F550 XLT Crew Cab Flatbed 4x4 • International 4900 S/A Refueler • Kenworth T300 S/A • Sterling LT9513 T/A.

21- SERVICE TRUCKS: 2009 Dodge 5500HD 4x4 • 2014 Dodge 5500 Crew Cab 4x4 • 2009 Dodge Ram 5500 S/A • Ford F650 • 2017 Ford F550 XLT Crew Cab 4x4 • 2014, 2013, 2012 & 2011 Ford F550 XLT 4x4 • Ford F550 • Ford F550 XLT 4x4 • 2- Ford F550 4x4 • Ford F450 4x4 • Ford F350 • Ford S/A • 2012 & 2011 Freightliner M2106 Extended Cab 4x4 • Freightliner M2106 4x4 Sleeper • 2012 GMC 3500HD Crew Cab 4x4 • 2011 GMC 2500HD Welding.

REEFER TRUCKS: Ford L9000 T/A • Freightliner • 2014 GMC 4500 • 2009 International 7500 Workstar T/A • International 4300 S/A • 2- 2014 Western Star 4700.

15- UTILITY TRUCKS: Dodge 4500HD SLT Crew Cab 4x4 • Ford F550 Crew Cab 4x4 • Ford F450 XLT 4x4 • 2015 Ford F350 XLT Extended Cab 4x4 • Ford F350 Crew Cab 4x4 • Freightliner M2 Extended Cab S/A Steam • GMC 3500HD Crew Cab 4x4 • Hino FB1817 COE S/A Steam • 2011 International 7500 T/A Boiler • International 7500 T/A Boiler • 2- 2012 & 2010 International 7400 T/A Boiler • International 4900 S/A Pressure Washer • 2011 Kenworth T370 S/A Steam.

ROLLBACK TRUCKS: 2012 Dodge 5500 4x4 • 2017 Freightliner M2112 T/A • Freightliner M2106 T/A • GMC T7500 S/A • Peterbilt 340 T/A.

21- VAN TRUCKS: Chevrolet 3500 Express • Dodge Ram 4500HD • Ford F550 XL S/A • 2010 Ford E450 Super Duty • Ford E450 S/A Cube • Ford E350 Cube • Freightliner M2106 S/A • Freightliner FL80 T/A • Freightliner Argosy Extended Cab T/A • GMC 3500 Savanna Cargo • GMC Savana Cutaway Cube • International 4300 DT466 S/A • 2- International 4300 S/A • 2014 International TerraStar S/A • 2009 Kenworth T300 S/A • Kenworth T300 S/A • Kenworth K100E T/A • 3- Peterbilt 330 S/A.

SANITATION TRUCKS: Freightliner T/A Front Loader Garbage.

ROLLOFF TRUCKS: Mack 700 T/A • 2009 Sterling T/A • Sterling T/A.

14- CAB & CHASSIS TRUCKS: Ford F550 XLT 4x4 • 2013 Freightliner FLD120SD Tri Drive Sleeper • Freightliner T/A Sleeper • GMC C7500 S/A • International 7500 T/A Sleeper • 2011 International 5900i Paystar Tri Drive • 2012 International 5900i Paystar Tri Drive • 2015 Kenworth T800 Tri Drive Sleeper • Mack R688ST T/A • Peterbilt 365 Tri Drive • Peterbilt • 2- Sterling LT9500 • 2012 Western Star 4900SA Tri Drive.

65- FLATBED TRUCKS: Crew Cab 4x4 • 2017 & 2013 Chevrolet 3500HD Crew Cab 4x4 • 2013 Chevrolet 3500HD LT Crew Cab 4x4 • 2010 Chevrolet 3500HD Crew Cab 4x4 • 3- 2010 Chevrolet 3500 Crew Cab 4x4 • Chevrolet 1533 S/A • 2009 Dodge 5500 Crew Cab 4x4 • 2014 & 2013 Dodge 3500 SLT Crew Cab 4x4 • 2014 Dodge 3500HD Crew Cab 4x4 • Ford F750 Extended Cab S/A • Ford F650 XLT S/A • 2012 Ford F550 XLT Extended Cab 4x4 • 2014 Ford F550 XL Crew Cab 4x4 • 2012 Ford F550 • 2012 Ford F550 Extended Cab 4x4 • Ford F550 XL Crew Cab 4x4 • Ford F550 XLT 4x4 • 2011 Ford F450 Crew Cab 4x4 • Ford F450 • Ford F450 XL Crew Cab 4x4 • 2015 Ford F350 XLT Crew Cab 4x4 • 6- 2015 Ford F350 XL Crew Cab 4x4 • 2014 Ford F350 XL Crew Cab • 2012 Ford F350 Crew Cab 4x4 • 2- 2012 & 4- 2011 Ford F350 XLT Crew Cab 4x4 • 2- 2010 Ford F350 XL Crew Cab 4x4 • 2- 2010 Ford F350 XLT Crew Cab 4x4 • Ford F350 • Ford F350 Crew Cab 4x4 • Ford F350 XL Crew Cab 4x4 • 2- Ford F350 XLT Crew Cab 4x4 • 3- GMC C5500 4x4 • GMC 5500 Crew Cab • GMC 4500 Crew Cab • 2014 GMC 3500HD SLE Crew Cab 4x4 • 2013 GMC 3500HD Extended Cab 4x4 • 2013 GMC 3500HD SLE Crew Cab 4x4 • 2012 GMC 3500HD Crew Cab 4x4 • 2012 GMC 3500HD SLE Crew Cab 4x4 • Hino FB COE S/A • 2013 International 7400 Workstar 4x4 • International 4700 S/A • International 4400SBA T/A • 2015 Ram 5500 4x4 • 2013 Ram 2500HD 4x4 • Sterling 9500 T/A.

EMERGENCY VEHICLES: Chevrolet 3500HD Rescue Unit • Chevrolet Ambulance • Ford C8000 COE S/A Fire Truck • Ford E450 S/A Ambulance • Unused - 2009 Ford E350 Ambulance • GMC 3500 Pump Truck • Superior S/A Fire Truck • Medical Transportation Centre MTC Unit.

TRUCKS: Ford LT9000 T/A Oil Distributor • International 5600i T/A T/A Coil Tubing • International 5600 T/A Down Hole Foam • Kenworth T800B Tri Drive Coil Tubing • Kenworth T300 S/A Toy Hauler • Mack CV713 Granite T/A Down Hole Foam • Volvo VHD84FT Shunt • Volvo ACL Cement Spreader T/A.

13- SPORTS UTILITY VEHICLES: 2015 Chevrolet Tahoe LT 4x4 • 2011 Chevrolet Equinox LT • Ford Explorer XLT 4x4 • Ford Explorer 4x4 • 2- Ford Escape • 2010 GMC Yukon 4x4 • 2013 GMC Yukon SLT 4x4 • GMC Envoy Denali XL 4x4 • 2012 GMC Yukon SLT • Jeep Wrangler TJ 4x4 • 2014 Jeep Patriot 4x4 • Pontiac Torrent AWD.

16- BUSES: 2- 2012 Chevrolet Express 8 Passenger AWD Crew Carrier • 2010 Ford E350 XL 15 Passenger Crew Carrier • Ford E150 XL 8 Passenger Crew Carrier • 2- 2011 Ford Econoline 15 Passenger Crew Carrier • Ford 4x4 Crew Carrier • Freightliner MB55 40 Passenger S/A Coach • Freightliner Bluebird 31 Passenger • International 3800 72 Passenger S/A • 2- International 3000 32 Passenger • International 48 Passenger • International 36 Passenger • 2010 International CE 32 Passenger 4x4 • 2013 International CE 18 Passenger 4x4.

AUTOMOBILES: Chrysler Sebring • 1931 Ford Model A • 1927 Ford TT • 2009 Ford Crown Victoria • 1928 Ford AA • Mercedes-Benz C280 • Toyota Camry.

41- LOWBOYS: Altek Tridem Tridem Scissorneck • Aspen HHT/RL 60 Ton 3+1 Combination • Aspen 50 Ton Tridem Scissorneck • 2013 Aspen 1+3 • Aspen Tridem • 2015 B&B Fab 50 Ton Tridem Tilt Deck • 2014 B&B Fab B1-50T533SA3 Tridem Tilt Deck • 2013 BWS 55LB3XLNF 55 Ton Tridem Scissorneck • 2012 BWS Scissorneck • Deloupe 66 Ton Tridem • 2014 Doepker 65 Ton 24 Wheel Scissorneck • Doepker 50 Ton Tridem • 2012 Doepker Tridem Scissorneck • Doepker Tridem Scissorneck • Dynameld 70XMG T/A Double Drop • 2013 Gerrys KLH403 Tridem Extendable Double Drop • Gerrys KSD50T-3 50 Ton Tridem Scissorneck • Gerrys FG40-3N Scissorneck • Gerrys 16 Wheel • Gerrys Tridem Scissorneck • Gerrys Tridem • King Lowboy PSV 16+32 Double Drop Steerable • K-Line 40 Ton Tridem Scissorneck • Liddell SDM05 50 Ton Tridem Double Drop • 2012 Load King SDX513 40 Ton Tridem • Load King • 2015 Matrixx 50 Ton Tridem Scissorneck • 2011 Muvall 53 Ft Tridem Double Drop • 2009 Peerless LB65SLRSOW24A 24 Wheel Scissorneck • 2- 2012 Peerless LB65SDLRSSOW24A 24 Wheel Scissorneck • Peerless LB65SDLRSSOW24A 24 Wheel Scissorneck • Peerless 60 Ton 3+1 Combination • Peerless LB65ODDBTMN16 60 Ton 16 Wheel • Peerless LB50LDBTMLN3A Combination • Rayfab 50 Ton Tridem Scissorneck • 2- Roadmaster T/A • Scona HHT/RL 16 Wheel Oilfield • 2012 Stellar 72 Ton 16 Wheel Double Drop • Trail King 2+3+2 Combination.

14- STEP DECK TRAILERS: 2015 Doepker 53 Ft Tridem • Doepker 53 Ft Tridem • 2010 Doepker 48 Ft T/A Spread Axle Combination • Fontaine 48 Ft Tridem • 2013 Great Dane FSD002600053 53 Ft Tridem • Lode King 53 Ft Tridem • 2014 Lode King 53 Ft T/A Aluminum Spread Axle • Manac 14348205 48 Ft Tridem • Manac 53 Ft Tridem • 2009 Manac 50 Ft T/A Spread Axle • Manac 48 Ft Tridem Trombone • Manac 48 - 65 Ft T/A Trombone • Roadmaster P4565W2DF 46 Ft T/A Trombone • Roadmaster 45 Ft T/A Trombone.

38- JEEPS: Advance S/A • Alco T/A Self-Steering Booster • Aspen 8 Wheel • 2013 Aspen S/A • Aspen S/A • 2014 Doepker JP16789-S T/A • 2014 Fontaine 302 T/A • Gerrys 16 Wheel • Gerrys KMPJ2 T/A • 2012 Gerrys T/A • Gerrys T/A Booster • Grand XL S/A • K-Line 4479-2 S/A • K-Line 4479-1 S/A • K-Line KJP108 S/A • 2012 K-Line KBA101 S/A Self-Steering Booster • K-Line 16 Wheel • M&M T/A Converter Dolly • Neils T/A • Nortrail 16 Wheel • Nortrail 8 Wheel • 2011 Pacesetter S/A • Peerless RJS2000W T/A • Peerless TAT202ASS T/A • 2012 Peerless JP45LP 16 45 Ton 16 Wheel • Peerless JP40C2A T/A Log • 2012 Peerless TAT20C2ASS 20 Ton T/A Booster • Peerless 16 Wheel Low Pro • Peerless S/A • 2- Peerless S/A Booster • Rotec R0JP4 S/A • Scona T/A • Temisko 5/Axle Steerable Beam Dolly • Trail King T/A Booster • Trail King T/A • S/A Converter Dolly • S/A Dolly.

16- SUPER B-TRAIN HIBOYS: 2013 Doepker 32 Ft Lead • Doepker 32 Ft Lead • 2013 Doepker 28 Ft Pup • Doepker 28 Ft • Doepker Pup • 2- Doepker Lead • 2- 2014 Doepker • 2- Doepker • Magnum 32 Ft Combination Lead • 2012 Manac 17332A040 32 Ft Lead Super B-Train • 2012 Manac 28 Ft Pup • Mond Lead • 28 Ft Combination Pup.

42- HIBOYS: BWS 53 Ft Tridem • Columbia S/A • 2- Doepker 53 Ft Tridem • Fontaine 40 Ft Tridem • Fruehauf 53 Ft Tridem • Fruehauf PBM1132480 45 Ft T/A • Fruehauf 26 Ft • 3- Fruehauf T/A • Fruehauf • Great Dane 53 Ft Tridem • Hobbs 35 Ft T/A • Hobbs T/A • 5- Lode King 53 Ft Tridem • 2- Lode King 48 Ft Tridem • 4- Lode King 48 Ft T/A • 4- Lode King 45 Ft T/A • Manac 53 Ft Tridem • 2009 Manac 48 Ft T/A Spread Axle • 2- Neils T/A • Scona T/A • Temisko 53 Ft Tridem • Trailmobile 48 Ft T/A • Trailmobile T/A • Wilson 48 Ft T/A Combination • Wilson 48 Ft T/A • 2- T/A.

PNEUMATIC BULK TRAILERS: Beall 1600 Cu Ft Tridem • Fruehauf Tridem • Fruehauf T/A • Tremcar Super B-Train Pup • Tremcar Super B-Train Lead.

30- OILFIELD FLOATS: Alco 50 Ft Tridem • Aspen OF50-3 50 Ton 45 Ft x 8 Ft 6 In. Tridem • 2014 Doepker PT17695S 42 x 9 Ft Tridem Picker • Doepker OF10537S 45 Ton 48 Ft x 8 Ft 6 In. Tridem • Doepker 45 Ton 48 Ft x 8 Ft 6 In. Tridem • Doepker 35 Ton 48 Ft x 8 Ft 6 In. Tridem • Fruehauf 42 Ft x 8 Ft 6 In. T/A • Fruehauf 40 Ft x 8 Ft 6 In. T/A • Gerrys Low Pro 60 Ton 35 Ft x 10 Ft 6 In. 16 Wheel • 2- Gerrys 45 Ton 48 Ft x 8 Ft 6 In. Tridem • JC Oilfield Tridem • Knight 40 x 11 Ft 16 Wheel • 2012 Load King 47 Ft x 8 Ft 6 In. Tridem Picker • Lode King 48 Ft x 8 Ft 6 In. Tridem Picker • 2013 & 2012 Lode King 45 Ft Tridem • Lode King 40 x 9 Ft Tridem Picker • Nortrail 44 Ft x 8 Ft 6 In. T/A • Peerless 53 x 10 Ft 24 Wheel Mid-range Low Pro • 3- Peerless Tridem • Scona 53 Ft Tridem • Scona 38 x 8 Ft T/A • Scona Tridem Picker • Scona Tridem • Scona T/A • XL Specialized 45 Ft x 8 Ft 6 In. Tridem • 62 Ton 48 x 10 Ft Tridem.

30- LOG TRAILERS & RIGGING: 2018 Arctic HR48QD 51 Ft x 9 Ft 6 In. Quad/A • 2014 Artic HR48QD • 2012 BWS 48 Ft Tridem Hayrack • Columbia CHUB329 22 x 8 Ft T/A • 2017 Cross Country 31 Ft x 9 Ft 6 In. Super B-Train Lead • 2017 Cross Country 21 Ft x 9 Ft 6 In. Super B-Train Pup • 2016 Peak 50 Ft Tridem Hayrack • Peerless R2500W Pole • Peerless CHUB329 29 Ft x 8 Ft 2 In. T/A Jeep • Peerless SLA266 22 Ft x 8 Ft 6 In. T/A • Peerless SLA266 28 Ft x 8 Ft 6 In. T/A Jeep • 4- Peerless 48 Ft Tridem Hayrack • 2- 2009 Peerless JP35SW2A T/A Jeep • 9- Peerless JP35SW2A T/A Log Jeep • 2- Superior 48 Ft Tridem Hayrack • 2- Timmins 48-3A60H-6 48 Ft Tridem Hayrack.

BOTTOM DUMP TRAILERS: 2014 Midland MG38MX3000 38 Ft Tridem • Midland MG38CLAM 38 Ft Tridem.

32- END DUMP TRAILERS: 2011 Arnes FD306 28 Ft Quad/A Full Frame • 2- 2014 Arnes 30 Ft Tridem • 2016 Arnes 29 Ft Tridem • 2009 Arnes 29 Ft T/A • Arnes 27 Ft Tridem • Arnes 25 Ft Quad/A Gravel Wagon • 2013 Arnes Tridem • Arnes Tridem • Arnes T/A • 2017 Bergs • Cancede 17 Ft Tridem Pup • 2013 Cancede 17 Ft Tridem Pup • Doepker SG12014S • Doepker 32 Ft Tridem • 2013 Gator 26 Ft T/A • 2012 Gravhaul FS335 31 Ft Tridem • Unused - 2018 Griffin 14 Ft T/A • Unused - 2018 Griffin 12 Ft T/A • Unused - 2018 Griffin 10 Ft T/A • Midland XL3000 30 Ft Tridem Full Frame • Midland 1G35SL300 • 2011 Neustar 35 Ft Tridem • Neustar Tridem Pup • Renn SL1700 17 Ft Tridem Full Frame Pup • 2013 Renn SL1400 17 Ft Tridem Full Frame Pup • 2009 Renn 17 Ft Tridem Pup • 2- Schien 14 Ft T/A Pup • Trojan 20 Ft 3/Axle Gravel Wagon • Trojan 20 Ft 3/Axle Aluminum Gravel Wagon • 30 Ft Quad/A Full Frame.

SIDE DUMP TRAILERS: 2010 Load Line 16 Ft T/A Lead.

16- CAR HAULER TRAILERS: Gorztagcar 18 Ft x 6 Ft 5 In. T/A • Load Trail 56 Ft x 8 Ft 2 In. Tridem • 2- Unused - 2019 Load Trail 24 Ft x 6 Ft 9 In. Tridem • Unused - 2018 Load Trail 24 Ft x 6 Ft 9 In. T/A • 2- Unused - 2018 Load Trail 24 Ft Tridem • 4- Unused - 2019 Load Trail 22 Ft x 6 Ft 9 In. T/A • Unused - 2019 & Unused - 2018 Load Trail 20 Ft x 6 Ft 9 In. T/A • Unused - 2019 Load Trail 18 Ft x 6 Ft 9 In. T/A • 2012 Rainbow Excursion 16 Ft x 6 Ft 10 In. T/A • Take 53 Ft x 8 Ft 6 In. Tridem.

CURTAIN SIDE TRAILERS: 2013 Wilson Super B-Train Pup • 2013 Wilson Super B-Train Lead.

REEFER TRAILERS: Great Dane 7811TZ-1AP 48 Ft x 8 Ft 6 In. T/A • Great Dane 7011TZ-1BA32 32 Ft x 8 Ft 6 In. T/A • Great Dane 7011TZ-1ASLT 48 Ft x 8 Ft 6 In. T/A • Great Dane 48 Ft x 8 Ft 6 In. T/A • 3- Great Dane 48 Ft.

GRAIN & SILAGE TRAILERS: Lode King Prestige 28 Ft Super B-Train Lead Grain.

26- VAN TRAILERS: 2013 Cjay CJ816-72-T60 16 Ft T/A Enclosed • 2012 Cjay CJ816-72-760 16 Ft T/A Enclosed • Continental Cargo 20 Ft T/A Enclosed • Forest River T/A Enclosed • Fruehauf 27 Ft x 8 Ft 6 In. S/A • Great Dane 48 Ft T/A • Interstate 20 Ft T/A Enclosed • JC 48 Ft T/A Office Enclosed • Manac 30 Ft Pup • 2015 Miron T/A Insulated Enclosed • 2014 Mirage M716TA3 16 Ft T/A Enclosed • 2014 Mirage MXL710SA 10 x 7 Ft S/A Enclosed • Unused - Mirage MXL508SA 8 x 5 Ft S/A Enclosed • 2014 Mirage MXL 16 Ft T/A Enclosed • 2013 Mirage MXSN8.528TA2 28 Ft T/A Heated ATV Enclosed • Pace American 20 Ft x 8 Ft 4 In. T/A Enclosed • 2018 Royal Cargo CGT70-824-78 32 Ft x 8 Ft 3 In. T/A Gooseneck Enclosed • 2014 Stealth SCH8520TA3 25 Ft x 8 Ft 6 In. T/A Enclosed • Stoughton 53 Ft x 8 Ft 6 In. T/A • Stoughton 53 Ft • Trailmobile 48 Ft x 8 Ft 6 In. T/A • Ubuilt 20 Ft x 8 Ft 4 In. Tridem Gooseneck Enclosed • Utility 53 Ft T/A • 2013 Vanguard 53 Ft x 8 Ft 6 In. T/A • Wells Cargo EW1624W 16 x 8 Ft T/A Enclosed • Wells Cargo FW272-VF 27 Ft x 8 Ft 4 In. T/A Enclosed.

VACUUM TRAILERS: Advance 5538 Gallon Quad/A • Custom Vac CV4300 4230 Gallon Tridem • Custom Vac QTC509 21476 Litre Quad/A • Hazeland Hydrospace T/A Hydro Vac • 2- 2014 & 2013 Rebel 17465 Litre Tridem Pup • Rebel 15593 Litre Tridem Pup • 2014 Tremcar.

16- TANK TRAILERS: 2011 Advance 46000 Litre Tridem • 2011 Advance 26000 Litre Quad/A Pup • Hamms T/A Pup • 2011 Hutchinson Tridem Pup • Lazer Inox LA42-3CR 42000 Litre Tridem • Red Deer CBF069 220 Barrel Cement Batch Mixer • 2016, 2015, 2- 2014 & 2009 Stephens 31800 Litre Quad/A • 2013 & 2012 Tremcar 32000 Litre Quad/A • Tremcar Quad/A • Wabash 25590 Litre 3/Axle Wagon • Westmark 23848 Litre T/A.

70- EQUIPMENT TRAILERS: 2013 ABU 40 Ft x 8 Ft 6 In. Tridem Gooseneck • Arnes 25 Ton 27 Ft x 8 Ft 6 In. T/A Tilt • Beothuck T/A • Big Tex 24 Ft x 8 Ft 6 In. T/A Gooseneck • Big Tex 22GN 22 x 8 Ft T/A Gooseneck • 2012 Big Tex 22 Ft x 8 Ft 6 In. T/A • Big Tex 4XPB24T T/A • Big Tex Gooseneck • 2017 Brandt UGR1124 29 Ft x 8 Ft 6 In. Tridem Gooseneck • 2013 BWS ANR Tridem • 2017 Canadian Trailers 24 Ft x 8 Ft 6 In. T/A Hyd Tilt • Custombuilt 25 x 8 Ft Tridem Gooseneck • Double A 28 Ft x 8 Ft 6 In. Tridem • Double A 12 x 8 Ft 6 In. S/A • Unused - 2018 ED Trailer 18 Ft x 6 Ft 9 In. T/A • Unused - 2018 ED Trailer 14 Ft x 6 Ft 9 In. S/A Galvanized Utility • Unused - 2018 ED Trailer 12 Ft x 6 Ft 9 In. S/A Galvanized Utility • Unused - 2018 ED Trailer 12 Ft x 6 Ft 4 In. S/A Galvanized Utility • 2018 Ed Trailer 12 Ft S/A Galvanized Utility • Unused - 2018 ED Trailer 10 Ft x 6 Ft 4 In. S/A Galvanized Utility • Unused - 2018 ED Trailer Mfg 10 x 5 Ft S/A Galvanized Utility • Felling FT40-2 31 Ft x 8 Ft 6 In. T/A • 2- 2013 Gator 29 x 8 Ft T/A Gooseneck • 2009 Hayshed 10 Ft x 5 Ft 6 In. S/A Utility • JC Trailer 34 x 9 Ft Tridem • 2011 Legend 34 Ft Tridem Gooseneck • Load Max 40 Ft x 8 Ft 6 In.

T/A Tilt Gooseneck • Load Max 24 Ft T/A • Unused - 2019 Load Trail 20 Ft x 6 Ft 9 In. T/A Sport Hauler • Unused - 2019 Load Trail 20 Ft T/A Tilt • Unused - 2018 Load Trail 18 Ft 8 Ft 6 In. • Unused - 2016 Load Trail 14 Ft x 6 Ft 9 In. T/A Dump Utility • Unused - 2018 Load Trail 14 Ft x 6 Ft 4 In. S/A • Merriman T/A • 2014 Norberts 30 Ft x 8 Ft 4 In. T/A • Norberts 29 Ft x 8 Ft T/A Gooseneck • 2015 Oasis 30 Ft x 8 Ft 6 In. T/A • 2012 PJ Trailers SY403 30 x 8 Ft Tridem Gooseneck • 2018 PJ Trailers FD363 36 Ft Tridem Gooseneck • 2011 PJ Trailers FS303 30 Ft x 8 Ft 6 In. Tridem Gooseneck • 2016 PJ Trailers 30 Ft x 8 Ft 6 In. Tridem Gooseneck • 2013 PJ Trailers 27 x 7 Ft Tridem Gooseneck • 2012 PJ Trailers 27 Ft Gooseneck • Unused - 2018 PJ Trailers 20 Ft T/A • Unused - 2018 PJ Trailers 18 Ft T/A • 2014 Precision FG40T15SP 48 Ft x 8 Ft 6 In. Tridem Gooseneck • RT 12 x 8 Ft S/A Utility • Saturn 34 x 9 Ft Tridem Tilt • Supreme T/A Utility • 2014 SWS 30 Ft Tridem Gooseneck • 2- 2011 SWS 22 Ft Tridem • 2013 SWS 14 Ft x 6 Ft 8 In. T/A Tilt Deck • Unused - 2018 TNT Trailer 18 Ft x 8 Ft 6 In. T/A Enclosed Car • Unused - 2016 TNT Trailer 14 x 7 Ft T/A Enclosed Cargo • Unused - 2019 TNT Trailer 12 x 6 Ft S/A Enclosed Cargo • Unused - 2018 TNT Trailer 10 x 5 Ft S/A Enclosed Cargo • Unused - 2018 TNT Trailer 7 x 14 Ft T/A Enclosed Cargo • 2- Unused - 2019 TNT Trailer 5 x 8 Ft S/A Enclosed Cargo • Trail King TK40 24 Ft T/A • Trail King 29 Ft x 8 Ft 6 In. T/A Tilt • 2- Trailtech TR240 L270 20 Ft T/A Tilt • Trailtech 29 Ft x 8 Ft 6 In. T/A Gooseneck • 2010 Trailtech 26 Ft Tridem • Unused - 2018 20 Ft T/A Utility • Unused - 2018 18 Ft T/A • Unused - 2018 10 Ft S/A Utility.

REEL TRAILERS: Dematco T/A • 2011 FalCan FL170 • Midwest S/A • Sauber S/A.

CONTAINER CHASSIS: Allied 20 Ft T/A • Aspen 20 Ft Tridem • 2013 Cross Country 40 Ft Tridem • 2- 2014 Hyundai CGN403-604 40 Ft Tridem.

32- TRAILERS: Altorfer Inc. 15 x 5 Ft T/A Generator • 2012 Cargo Mate ORBL816TA4 16 x 8 Ft T/A Pressure Wash • 2009 Cargo Mate 16 Ft x 7 Ft 9 In. T/A Heated Pressure Wash • 2013 Cargo Mate 16 Ft T/A Pressure Wash • Charmac 15 Ft T/A Enclosed • Custombuilt T/A Tank Cradle • Custombuilt Tank Cradle • 2011 Falcan S/A Service Body • 2014 Forest River ORCCG828TTAS 28 Ft Tridem Heated Pressure Wash • 2011 Forest River ORBL816TA4 16 Ft T/A Heated • 2011 Gentex DF44 14000000 BTU Super Heater • 2017 H&H 10 x 5 Ft T/A • 2015 Load Trail Tridem Dump • Lode King 48 Ft T/A Sand Blast • Nortruck BBQ • Unused - 2018 PJ Trailer Mfg T/A Buggy Hauler • Unused - 2018 PJ Trailers 10 Ft T/A Dump • 2013 Rainbow T/A Coil Heat Exchanger • 2013 Rainbow T/A Acid Heater • Snake 10 Ft x 6 Ft 4 In. T/A Dump • 2014 Trail King OLB334NGSP1F Tridem Live Bottom • 2013 Trailtech L370HD 16 x 7 Ft Tridem Gooseneck Dump • 9- 5 Ft x 2 Ft 3 In. S/A Welding • 2013 Water Cannon.

100- MOBILE STRUCTURES: Albert Modular Inc 60 x 12 Ft Field Office/ Lunchroom • Alberta Modulares Inc SEA2FO03 60 x 12 Ft Field Office • 2- 2012 Alta-Fab 121260SWSEE 60 x 12 Ft Double-Ended Wellsite • 2010 Alta-Fab 112260SWSEE 60 x 12 Ft Skid Double-Ended Wellsite • Alta-Fab 60 x 12 Ft Washcar • Alta-Fab 56 x 12 Ft Wellsite • Alta-Fab 54 x 12 Ft Double-Ended Wellsite • Alta-Fab 54 x 12 Ft Wellsite • Alta-Fab 48 x 12 Ft Wellsite • Arctic 30 x 10 Ft Wellsite • Arcticor 60 x 12 Ft Field Office/Lunchroom • Atco 60 x 12 Ft Field Office • Atco SEA2LR18 60 x 12 Ft Field Office • Atco Field Office • Britco Field Office • 2014 Campcorp Structures Super Single 60 x 12 Ft Wellsite • Cover-all 80 x 55 Ft Portable Fabric Shelter • Cover-all 32 x 70 Ft Portable Fabric Shelter • 2- Custom Built 28 x 8 Ft Tridem Office Trailer • Custom Structure 54 x 10 Ft Field Office • Double A Trailers Job • Envirobin 47 Ft x 11 Ft 6 In. Washcar • FSI 60 x 12 Ft Double-Ended Wellsite • 2- Gemco 40 x 12 Ft Office Trailer • Gemco 38 x 12 Ft Sleeper • 2- Gemco 32 x 10 Ft T/A Wellsite • 2- Gemco 28 Ft

Wellsite • 5- Gemco 24 Ft Wellsite • 3- GNS 60 x 12 Ft Wet Sleeper • 3- 2013 Inovate 60 x 12 Ft Field Office • Misi 60 x 12 Ft Field Office • Mobil Fab 30 x 12 Ft Washcar • 3- 2012 Modspace 60 x 12 Ft Field Office • 2012 Modus Solutions Apollo 35 x 10 Ft Office Trailer • Mountain View 30 Ft Tridem Wellsite • 2- Northgate 6000 Gallon Water Storage • Northgate 12 x 32 Ft Lavatory Washcar • 2010 PJ Trailers 15162 20 Ft x 8 Ft 6 In. T/A Kitchen • Rapid Camp 60 x 12 Ft Eng/Eng Wellsite • 2014 Red Rose JRR1007 60 x 12 Ft Field Office • Travco 50 x 11 Ft • Westlake 30 Ft Wellsite • Westlake 28 Ft Wellsite • Williams Scotsman 60 x 12 Ft Field Office • 2012 Forest River Housing Inc. 2102012 76 x 16 Ft Modular Home • Winalta 2150172 x 20 Ft Modular Home • 2012 Wash A7 40 x 8 Ft Modular Washcar • 3 Unit 10 Man Sleeper/Washcar Frameless Camp • 12- Mobile Toilet • Light Plant • 3- Field Office • 2012 & 2- 2011 60 x 14 Ft 4 Man Sleeper • 2012 60 x 14 Ft Sleeper • 2012 & 7- 2011 60 x 12 Ft Wellsite • 28 x 10 Ft Storage Building • 24 x 11 Ft RLTL Lavatory • 20 x 8 Ft Support Unit • 20 x 8 Ft Washcar • 16 x 8 Ft Washcar • 16 Ft x 7 Ft 6 In. Storage Building • 12 x 6 Ft.

Other items of interest

17- TELESCOPIC FORKLIFTS: Carelift ZB10055-44 4x4x4 • Caterpillar TH560B 4x4x4 • 2015 Gehl RS519 4x4x4 • 2- Unused - 2018 Genie GTH3007 4x4x4 • 4- Unused - 2018 Genie GTH2506 4x4x4 • JBC 550-170 4x4x4 • 2012 JCB 550-170 4x4x4 • 2014 JCB 510-56 4x4x4 • 2012 & 2011 JCB 510-56 • Manitou MRT2440 • 2011 Manitou MRT1635 4x4x4 • 2016 Skytrak 10042 4x4x4.

ROUGH TERRAIN FORKLIFTS: Manitou M50-4 4x4.

15- FORKLIFTS: Clark C80 • Doosan G25P-5 • Hyster H155XL2 • Hyster S80XMBCS • Hyster S80XLBCS • Linde H25T • Nissan MCPL02A25LV • Sellick SD80 2WD • Sellick TMF55 Piggyback • Toyota 42-6FGU25 • 2- Toyota 7FGU45 BCS • Toyota FG7 • V-Lift SF25L • Yale G83P-050-SAT-07 Type G.

SCISSORLIFTS: 2011 Genie GS3246 • MEC 2033ES Electric • Skyjack SJ8831.

BOOM LIFTS: Genie Z45/25 Articulated • 2011 & 2010 Genie GR15 • 2010 Genie GRC12 Electric • JLG 800AJ 4x4 Articulated • 2011 JLG 20MVL • JLG 20MVL.

4WD AGRICULTURAL TRACTORS: John Deere 9420.

BELTED AGRICULTURAL TRACTORS: 2009 Challenger MT865C • Challenger MT865B.

10- MFWD AGRICULTURAL TRACTORS: Case IH MXU130 • John Deere 9400 • John Deere 7710 • 2009 John Deere 6430 • 2012 John Deere 6170R • 2014 John Deere 6170M • John Deere 4760 • 2010 Kubota M135X • Kubota M125X • Massey Ferguson 8140.

2WD AGRICULTURAL TRACTORS: New Holland 8360.

13- UTILITY TRACTORS: John Deere 4115 4WD • Kubota M6800 • 2010 Kubota M6040D • Kubota M6040D • Kubota L4200 • 8- Kubota BX25.

COMBINES: 2014 & 3- 2013 John Deere S680.

SEEDING EQUIPMENT: 2011 Brillion SSP-8 8 Ft • Brillion SSP-8 8 Ft • DuraTech 77 7 Ft 7 In. Double Disc No Till Drill • John Deere 1500 3 Pt Seed Drill.

CULTIVATORS: Free Form 1000 80 In. 2 Row 3 Point.

10- DISCS: Agri-Tillage 13 Ft • John Deere 11 Ft 6 In. Offset • Kello-Bilt 325-2928B 15 Ft Breaking • Kello-Bilt 325-2130B 9 Ft Offset • Kello-Bilt 9 Ft Offset • Kirchner Straw Crimper • Land Pride DH2596 8 Ft Offset • Stiger 1715 12 Ft • Wilbeck 1630 10 Ft Offset • 84 In.

PLOWS: Tye Paratill.

SPRAYER & SPREADING EQUIPMENT: Terragator 3 Wheel.

ALL TERRAIN VEHICLES: 3- Argo 750 HDI 8x8 Amphibian Unit • 2013 Argo Titan HD 8x8 • Foremost Delta 3C 6x6 Deck Carrier • Foremost Delta 3 6x6 Deck Carrier • Hagglund BV206 Crawler Crew Carrier • 2015 IHI IC50 Personnel Carrier • Rolligon Articulated.

SNOW EQUIPMENT: 2011 Maclean MV2 Sidewalk Plow • Maclean MV Sidewalk Plow • Massey Ferguson 8220 MPWD • LMC 3700CF Snowcat • 4- Pisten Bully PB600 Snowcat • 2- Pisten Bully PB400 Snowcat • Pisten Bully PB260 Snowcat • 2- Pisten Bully PB200 Snowcat • Pisten Bully 200 Snowcat • 2013 Prinoth BR350 Snowcat • Prinoth BR275 Snowcat • Prinoth Bison X Snowcat • 2013 & 2012 Prinoth Bison Snowcat • Snow Making Machine.

STREET SWEEPERS: Elgin Eagle F • Johnston 4000 • Tennant 8600 Scrubber.

COMMERCIAL VESSELS: 2- 2011 Dragflow DRH400 Submersible Dredge.

DRILL TRUCKS: Western Star 4900SA T/A Tri Drive Rod Rig.

RECREATIONAL VEHICLES: CAN-AM 500 4x4 Quad • 2- Club Car Electric Golf Cart • Ford 150 Van/Amera Econoline Camperized Van • Qty of Unused - GSC V2 Electric Skate Caddy Golf Cart • 2012 Heartland 3950 Cyclone 41 Ft Tridem Toy Hauler Fifth Wheel Travel Trailer • Hilltop Customs Softail Motorcycle • 4- 2016 Honda SXS500M 4x4 Side By Side ATV • 2013 Honda Foreman ES 450 4x4 Quad • Honda Foreman ES 450 4x4 Quad • Honda Foreman 450ES Quad • Kawasaki KVF650A Quad • Kit Manufacturing Sportsmaster 29 Ft T/A Fifth Wheel Travel Trailer • Lance Squire 185 15 Ft Camper • Monaco Camelot Class A 42 Ft S/A Motor Home • 2011 Polaris 800 4x4 Side By Side ATV • Polaris 600 Snowmobile • Puma PT30FQSS 30 Ft T/A Travel Trailer • Roadmaster Holiday Rambler Navigator 45 PBT Motor Home • Roadway 20FWTB 20 Ft T/A Fifth Wheel Travel Trailer • 2009 Scandic Tundra Snowmobile • 2010 Sierra F300 T/A Fifth Wheel Travel Trailer • 2012 Ski-Doo Rev XP Grande Touring 600 Snowmobile • 2012 Ski-Doo Grand Touring Snowmobile • 2012 Ski-Doo Back Country X Snowmobile • 2013 Summit 800 Snowmobile • 2- Unused - 2017 1000 Watt Electric ATV • 2- Unused - 1000 Watt Electric ATV.

UTILITY VEHICLES: 2013 Arctic Cat Wildcat 1000 4x4 • 2013 John Deere Gator XUV 4x4 Side By Side • 2017 Polaris Ranger XP1000 4x4 Side By Side • 2013 Polaris Ranger XP900L • 2016 Polaris Ranger RGR 900 4x4 • 2009 Yamaha Rhino 700 Special Edition Side By Side.

PLEASURE CRAFT: Starship Hover Craft 13 Ft.

INDUSTRIAL GENERATOR SETS: Caterpillar 3456 SR4 400 KW • Caterpillar 3412 DIT 350 KW • Leroy-Somer 415 KW Skid Mtd • Magnamax • Stamford 600 KW Skid Mounted • Stamford 305 KW.

GENERATOR SETS: BBC 713 800 KW Skid Mtd • BBC 710 800 KW Skid Mtd.

ITEMS INCLUDE: 159- Pickups • 34- Walk Behind Compactors • Tow Behind Rollers • Scales • Aggregate Equipment • Electric Forklifts • Harrow Bars & Packers • Breaking Equipment • Mowers • Haying Equipment • Irrigation Equipment • Pull Scrapers • Agricultural Equipment • Landscape Equipment • Livestock Equipment • Sewer & Water • 31- Air Compressors • 21- Consumer Generator Sets • 57- Light Generator • 99- Light Towers • 47- Welders • 69- Pumps • 79- Tanks • Concrete Equipment • Survey Equipment • Drill Parts & Accessories • Pipeline Equipment • 56- Containers • Industrial Plant Equipment • 26- Engines • Crane Accessories • Equipment Attachments • Demolition & Recycling Attachments • Tractor Attachments • Truck Attachments • Industrial Items • Equipment Parts • Shop & Warehouse Items • Part & Stationary Items - Construction & Transportation.

It's back for a limited time only

NO PAYMENTS FOR 120 DAYS*

Apply today
*OAC. Terms and conditions apply.

Call 1.855.331.7237 or visit rbauction.com/Flex

BID & BUY ON THE GO!



Download the
Ritchie Bros. app today.

rbauction.com/app



Visit rbauction.com

for detailed equipment information
and photos.

Reminder: Don't wait until the last minute to bid!

2013 Cat 349EL Track Excavator KS 876880 2013 Kenworth T660
Bidding closes in: 2 min, 37 sec* (extended)
Highest bid US \$152,000 Bid US \$153,000
54 bids

2013 Kenworth T660 Bidding closes in: 2 min, 37 sec* (extended)
Highest bid US \$35,000 36 bids

2008 Prentice TX 755918
2008 Prentice
Winning bid US \$105,466

2008 Cat 12M Motor Grader AZ 863858
Bidding closes in: 3 min, 37 seconds*
Highest bid US \$61,000 Bid US \$62,000
21 bids

2012 Cat Bidding closes in: 3 min, 37 seconds*
Highest bid US \$71,150

2011 International 4300 Cab & Chassis NC 876883 2013 Kenworth
Bidding closes in: 3 min, 37 seconds*
Highest bid US \$11,500 Bid US \$12,000
3 bids

2013 Kenworth T660 Bidding closes in: 3 min, 37 seconds*
Highest bid US \$2,190

View All Items Later Today by Type

Item # Description

Jarvis WH75 Right of Way Saw

2011 John Deere 210DL 4x4 Landscape w/ Sleeper

2013 Kenworth T660 T/A Conventional w/ Sleeper

2009 Volvo Articulated

2010 International ProStar Premium T/A Conventional Day Cab

2006 Cat 308C CR Mini Excavator

Explore More Equipment

Check IronPlanet's weekly
online equipment auctions

ironplanet.com

IRON PLANET

Upcoming auctions around the world

Canada

Chilliwack, BC	Oct 10
Saskatoon, SK	Oct 11
Brandon, MB	Oct 16
Edmonton, AB	Oct 23–26
Regina, SK	Nov 6
North Battleford, SK	Nov 8
Lethbridge, AB	Nov 28
Edmonton, AB	Dec 11–12
Montreal, QC	Dec 17–18

USA

Las Vegas, NV	Oct 12
Pittsburgh, PA	Oct 30
Salt Lake City, UT	Nov 5
Houston, TX	Nov 6–7
Lincoln, NE	Nov 9
Tipton, CA	Nov 13
Orlando, FL	Nov 13
Kenmare, ND	Nov 15
Flaxton, ND	Nov 16
Phoenix, AZ	Nov 16
Kansas City, MO	Dec 3
Sacramento, CA	Dec 4

International

Irvine, SCO	Oct 16
Northam, AUS	Oct 25
Narita, JPN	Oct 29–30
Donington Park, UK	Nov 20–21



2 – 2013, 2 – 2012 & 2 – 2010 CMI C175



Caterpillar 730 6x6



2011 International 5900i Paystar Rod Rig Flushby



2 – 2013 Caterpillar 160M2 AWD VHP Plus

See complete auction and equipment information on our website

rbauction.com



2014 John Deere S680



2013 Tadano GR350XL-2 35 Ton 4x4x4



1 of 2 – 2013 Caterpillar 938K

Equipment videos, photos, auction news and more.
Like us on [facebook.com/RitchieBros](https://www.facebook.com/RitchieBros)



Scan using your device's camera or a QR code reader.

Edmonton, AB | October 23–26, 2018 (Tue–Fri)

rbauction.com

rb RITCHIE BROS.
Auctioneers®

60
YEARS